

Owners Name: _____
 Property Address: _____
 Contact phone number: _____
 Assessor's Parcel Number: _____
 Scale: _____

Any permit issued pursuant to the approval of this plot plan DOES NOT authorize violation of any covenant, condition or restriction which may apply to your land. If your property is in a planned development, check with your property owners association before building. Grading _____ C.Y.

**** ALL MOBILE HOMES MUST BE 10 YEARS OR NEWER **** Disturb _____ S.F.

THE FOLLOWING INFORMATION MUST APPEAR ON THIS PLOT PLAN:

1. Property boundary dimensions, parcel size, building setback and easements.
2. Encroachment location & driveway from structure to private, public or State Right of Way.
3. All existing structures on the property, shown at appropriate scale.
4. Utility services (gas, water, sewer or septic system, and electric service). Propane tank shall be no closer than 10 ft. to property line, structure or source of ignition.
5. Locations of any slope on the property. If the structure is in any way impacted by a slope not identified on the plot plan, the inspector will stop the building from processing and require the re-submittal of plans to the Building Department. (CBC 1808A.7.1&2)
6. Indicate amount of grading in cubic yards and amount of surface disturbed.

THIS PLAN SHALL INDICATE AN ACCURATE TRUE

Plot Plan Must Be Fully Completed. If Not We Will Not Sign Off The Plot Plan

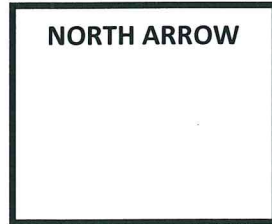

PERMIT ISSUANCE APPROVAL

PLANNING DEPARTMENT

Zoning: _____ Meets Setbacks

Private Road Public Road

Grading (see encroachment info below)

Approved For: _____

By: _____ Date: _____

PM # _____ TPM# _____ MMP N/A

BUILDING AND SAFETY DEPARTMENT

Use: _____ Occupancy: _____

Flood Map # _____ Zone _____ In Out Charge

Water Source: Ground Other Treated with : _____

By: _____ Date: _____

ENVIRONMENTAL HEALTH DEPARTMENT

Approved With compliance to correction on plan regarding:

- Sewage Disposal Existing Required
- Well Location Existing Required
- Structural (Not Well or Septic)

By: _____ Date: _____

Approved for: _____

COUNTY FIRE- CAL FIRE

Tehama County Fire Department Requirements (Ordinance 1537)
 Ordinance 1537: Article(s) I-Administration, II-Emergency Access,
 III-Signing and Building Numbering, V-Fuel Modification Standards

Setbacks:

- Building is 30' or more from property line/center of road
- Building is less than 30' from property line/center of road
- Same Practical Effect Requirements Required

Other:

- Fire Flow Required (CFC Appendix B)
- Fire Hazard Abatement (Ordinance # 1912.9.05)
- Vehicle Impact Protection Required
- Sprinklers Required (CRC)
- Sprinklers Required (Ordinance # 1964)

By: _____ Date: _____

Approved for: _____

PUBLICWORKS

(Tehama County Ord. 1708 § 2(part) 1999, Code 15.02.340)

Grading: YES NO Over 250 Cubic Yards

- Disturbs 10,000+ s.f. Within 250' of Water Course
- Road Construction/Building Pad Grading Permit Required

County Engineer Certificate Required for Building in zones :
 C-1, C-2, C-3, C-4, M-1, M-2, R-3, R-4

Encroachment Permit Required for County Maintained Road in all zones

By: _____ Date: _____